

### PERSPECTIVE VIEW 1

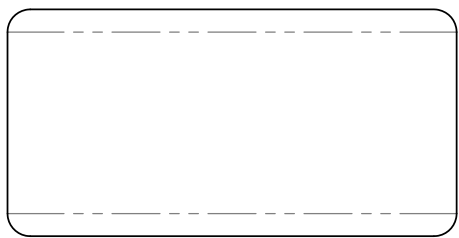

FRONT VIEW

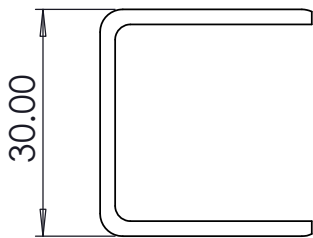

### RIGHT VIEW

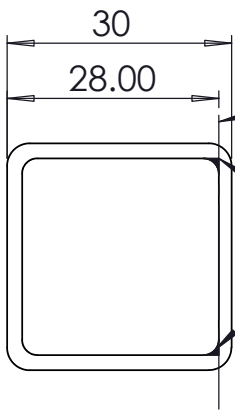

RIGHT VIEW  
BEFORE CUTTING

CUTTING LINE

DEPENDING ON THE SELECTED MATERIAL PROFILE, THE INTERNAL FILLETS MAY REQUIRE REMOVAL VIA GRINDING FOLLOWING CUTTING

## OPTION 2: CUT SQUARE HOLLOW SECTION

<div>TOLERANCES</div> <ul style="list-style-type: none"><li>Tolerances to ISO 2768-mK unless otherwise stated.</li><li>For dimensions under 0.5mm tolerance is ±0.05.</li><li>ISO 2768-1: Per below table (class indicated by check mark).</li><li>ISO 2768-2: K (medium)</li></ul>							<div>DIMENSIONS</div> <ul style="list-style-type: none"><li>All dimensions are in millimetres unless otherwise indicated.</li><li>Critical inspection dimension: </li><li>Dimensions with ** may require adjustment during tool trials.</li><li>First article inspection number:  (supplier to provide a report detailing accuracy to each of these dimensions).</li><li>Other dimensions for reference.</li></ul>							<div>PART SUPPLY</div> <ul style="list-style-type: none"><li>Break all sharp edges R0.2 max.</li><li>Cosmetic surfaces to be free of scratches, tool marks, and gouges.</li><li>Part to be clean and free of oil, grease, and other foreign contaminants.</li><li>Remove dross and tabs from cut edges</li><li>Minimise handling marks on all external surfaces.</li><li>Minimise tooling/die marks on external bends.</li><li>No visible cracking/crazing permitted on bends.</li></ul> <div>PAINING:</div> <ul style="list-style-type: none"><li>Mask all areas indicated. No paint permitted on masked surfaces.</li><li>Finish to be uniform in color, gloss, and texture across all visible surfaces. Painted surface shall be free of runs, sags, orange peel, fisheyes, cratering, blisters, and embedded foreign particles (dust, fibres).</li></ul> <div>INSTALLED HARDWARE (PEMs, standoffs, studs):</div> <ul style="list-style-type: none"><li>Inserted hardware to be seated flush to 0.2mm proud.</li><li>Installed hardware must be perpendicular to the surface within 1°.</li></ul>							<div>-- --</div> <div>-- --</div> <div>-- --</div> <div>-- --</div> <div>-- --</div> <div>-- --</div> <div>-- --</div> <div>-- --</div> <div>-- --</div> <div>-- --</div> <div>-- --</div> <div>02 Width reduced, pos change</div> <div>01 Initial Release</div> <div># DESCRIPTION</div> <div>DATE</div>			<div>DESIGN INTENT</div> <div>Unless otherwise specified, fabricate per this drawing. The 3D model represents the final formed condition for reference.</div> <div>PROJECT NAME</div> Fishing Rod Spike <div>DRAWING TYPE</div> Part Drawing <div>DATE CREATED</div> Monday, 15 September 2025 <div>NOTES:</div>		<div>© COPYRIGHT</div> <div>This drawing is supplied in confidence. Do not disclose to any third party without prior written consent from Manufacturing Skills Queensland</div> <div>COLOUR:</div> Self-Colour <div>FINISH:</div> Self Finish <div>MATERIAL:</div> 30 x 30 x 2mm SHS		<div>MANUFACTURING SKILLS QUEENSLAND</div> <div>monoChromewww.monochrome-design.com</div>		<div>PART NAME:</div> <div>MONO_038-p209</div> <div>DESCRIPTION:</div> <div>Foot Bar Support</div> <div>DO NOT SCALE DRAWING</div> <div>SCALE:1:1</div>		<div>A3</div> <div>SHEET 2 OF 2</div>																																																					
<div>LINEAR - PERMISSIBLE DEV. IN MM FOR RANGES IN NOMINAL LENGTHS</div> <table><tr><th></th><th>CLASS</th><th>0.5 - 6mm</th><th>6 - 30mm</th><th>30 - 120mm</th><th>120 - 400mm</th><th>Over 400mm</th></tr><tr><td><input type="checkbox"/></td><td>FINE</td><td>±0.05mm</td><td>±0.1mm</td><td>±0.15mm</td><td>±0.2mm</td><td>±0.3mm</td></tr><tr><td><input checked="" type="checkbox"/></td><td>MEDIUM</td><td>±0.1mm</td><td>±0.1mm</td><td>±0.3mm</td><td>±0.5mm</td><td>±0.8mm</td></tr><tr><td><input type="checkbox"/></td><td>COARSE</td><td>±0.3mm</td><td>±0.5mm</td><td>±0.8mm</td><td>±1.2mm</td><td>±2.0mm</td></tr></table>								CLASS	0.5 - 6mm	6 - 30mm	30 - 120mm	120 - 400mm	Over 400mm	<input type="checkbox"/>	FINE	±0.05mm	±0.1mm	±0.15mm	±0.2mm	±0.3mm	<input checked="" type="checkbox"/>	MEDIUM	±0.1mm	±0.1mm	±0.3mm	±0.5mm	±0.8mm	<input type="checkbox"/>	COARSE	±0.3mm	±0.5mm	±0.8mm	±1.2mm	±2.0mm	<div>ANGULAR - PERMISSIBLE DEV. IN DEGREES &amp; MINUTES FOR RANGES IN NOMINAL LENGTHS</div> <table><tr><th></th><th>CLASS</th><th>0 - 10mm</th><th>10 - 50mm</th><th>50 - 120mm</th><th>120 - 400mm</th><th>Over 400mm</th></tr><tr><td><input type="checkbox"/></td><td>FINE</td><td>±1 °</td><td>±0°'30'</td><td>±0°'20'</td><td>±0°'10'</td><td>±0°'5'</td></tr><tr><td><input checked="" type="checkbox"/></td><td>MEDIUM</td><td>±1 °</td><td>±0°'30'</td><td>±0°'20'</td><td>±0°'10'</td><td>±0°'5'</td></tr><tr><td><input type="checkbox"/></td><td>COARSE</td><td>±1 ° '30'</td><td>±1 °</td><td>±0°'30'</td><td>±0°'15'</td><td>±0°'10'</td></tr></table>								CLASS	0 - 10mm	10 - 50mm	50 - 120mm	120 - 400mm	Over 400mm	<input type="checkbox"/>	FINE	±1 °	±0°'30'	±0°'20'	±0°'10'	±0°'5'	<input checked="" type="checkbox"/>	MEDIUM	±1 °	±0°'30'	±0°'20'	±0°'10'	±0°'5'	<input type="checkbox"/>	COARSE	±1 ° '30'	±1 °	±0°'30'	±0°'15'	±0°'10'	<div>SURFACE TEXTURE KEY (RA STANDARD)</div> <div>Refer to 3D part and surface finish sheet for application</div> <table><tr><td>Orange</td><td>Deburr</td><td>RA 3.2</td></tr><tr><td>Green</td><td>Smooth</td><td>RA 1.6</td></tr><tr><td>Blue</td><td>Polish</td><td>RA 0.9</td></tr></table>							Orange	Deburr	RA 3.2	Green	Smooth	RA 1.6	Blue	Polish	RA 0.9
	CLASS	0.5 - 6mm	6 - 30mm	30 - 120mm	120 - 400mm	Over 400mm																																																																															
<input type="checkbox"/>	FINE	±0.05mm	±0.1mm	±0.15mm	±0.2mm	±0.3mm																																																																															
<input checked="" type="checkbox"/>	MEDIUM	±0.1mm	±0.1mm	±0.3mm	±0.5mm	±0.8mm																																																																															
<input type="checkbox"/>	COARSE	±0.3mm	±0.5mm	±0.8mm	±1.2mm	±2.0mm																																																																															
	CLASS	0 - 10mm	10 - 50mm	50 - 120mm	120 - 400mm	Over 400mm																																																																															
<input type="checkbox"/>	FINE	±1 °	±0°'30'	±0°'20'	±0°'10'	±0°'5'																																																																															
<input checked="" type="checkbox"/>	MEDIUM	±1 °	±0°'30'	±0°'20'	±0°'10'	±0°'5'																																																																															
<input type="checkbox"/>	COARSE	±1 ° '30'	±1 °	±0°'30'	±0°'15'	±0°'10'																																																																															
Orange	Deburr	RA 3.2																																																																																			
Green	Smooth	RA 1.6																																																																																			
Blue	Polish	RA 0.9																																																																																			